

TUSP1

CANISTER LOAD CELL



Super Precision and Reliability Inside a Stainless Steel Housing.

- ✓ **Capacities from 250 lbs. to 100K - IN STOCK!**
- ✓ **Stainless Steel Housing.**
- ✓ **Exceeds NEMA 6 and IP67 hosedown.**
- ✓ **Hermetically Sealed.**
- ✓ **Reliable - Durable - Precise.**
- ✓ **30 ft. Cable or Optional Connector.**



Totalcomp[®] Scales & Components

99 Reagent Lane • Fair Lawn, New Jersey 07410
Fax: 201-797-2287 • Toll Free Fax: 888-797-2288 • Phone: 201-797-2718 • Toll Free Phone: 800-631-0347
Email: sales@totalcomp.com • Website: www.totalcomp.com

Models TUSP1

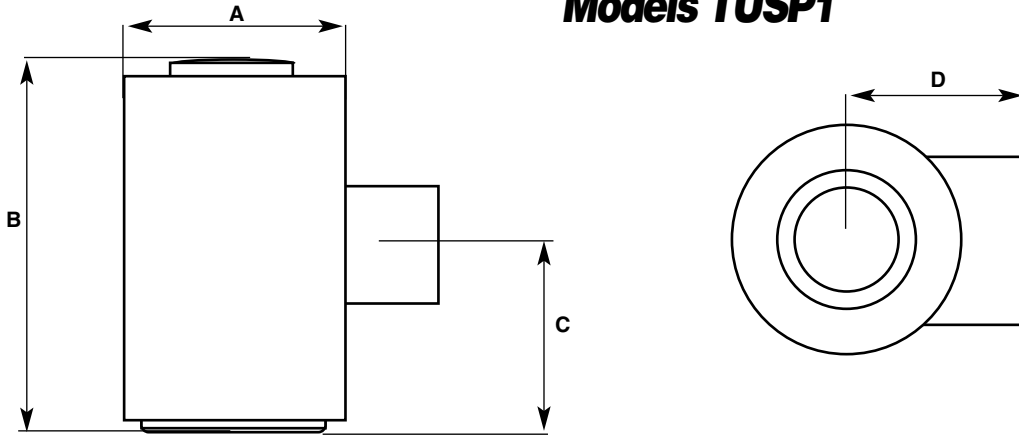

STAINLESS STEEL CANISTER LOAD CELL

The *Totalcomp* TUSP1 is a canister type load cell of premium quality. Designed for use in applications which require high linearity and reliability. The hermetically sealed, stainless steel housing provides superior protection in areas exposed to foreign particles and/or corrosive substances.

Part Number	Capacity	Weight	A	B	C	D	Thread
TUSP1-250-SS	250 lb	6 lb	2.00	3.32	1.70	2.26	3/8-24 UNF
TUSP1-500-SS	500 lb	5 lb	2.50	4.45	2.20	2.31	1/2-20 UNF
TUSP1-1K-SS	1,000 lb	6 lb	2.50	4.45	2.20	2.31	1/2-20 UNF
TUSP1-2.5K-SS	2,500 lb	5 lb	2.25	3.00	1.56	2.69	1/2-20 UNF
TUSP1-2.5K-HT-SS*	2,500 lb	5 lb	2.25	3.00	1.56	2.69	1/2-20 UNF
TUSP1-5K-SS	5,000 lb	9 lb	3.00	5.75	2.81	3.06	1"-14 UNF
TUSP1-10K-SS	10,000 lb	10 lb	3.00	5.75	2.81	3.06	1"-14 UNF
TUSP1-25K-SS	25,000 lb	21 lb	4.00	8.38	5.87	3.56	1 1/2"-12 UNF
TUSP1-50K-SS	50,000 lb	44 lb	6.25	11.44	5.72	3.56	2"-12 UNF
TUSP1-100K-SS	100,000 lb	106 lb	9.00	17.75	8.75	-	3" UNF

* High Temperature 400 def F w/50 ft cable

Performance

Full Scale Output

3.00 mV/V

Combined Error

±0.05% FS

Nonlinearity

±0.05% FS

Hysteresis

±0.03%

Creep

±0.02% FS in 1 hour

Non-Repeatability

±0.01% FS

Zero Balance

±1% FS

Overload, Safe

150% FS

Overload, Ultimate

300% FS

Electrical

Bridge Resistance

Input 350 ohms

Output 350 ohms

Excitation Voltage

10VDC (15VDC Max)

Insulation Resistance

5KM ohms@50VDC

Temperature

Compensated Range

10°F to + 110°F

Temperature Operating Range

10°F to + 110°F

Effect on Zero Balance

0.0015% FS/deg F

Effect on FS Output

0.0008% FS/deg F

Mechanical

Material

Stainless Steel

Finish

Polished

Sealing

IP67

Wiring

Cable Length & Type

30 foot, 4 conductor

Cable Color Code

+ ExcitationGreen

- ExcitationBlack

+ OutputWhite

- OutputRed

ShieldBare

TOTALCOMP LIMITED WARRANTY

Totalcomp warrants this product to be free of defects in materials and/or workmanship and suitable for the purpose(s) intended as outlined on this sheet. This warranty is effective and shall cover the purchaser for one year from the date of shipment from our plant. If this product is found to be defective by our inspection in accordance with the above listed criteria, we will replace or repair it at our expense. For warranty service, please obtain a return authorization number from us and return the item, shipping prepaid, with a written description of the problem. We will respond promptly with the results of our evaluation.



Totalcomp®

Scales & Components

99 Reagent Lane

Fair Lawn, NJ 07410

Fax (201) 797-2287

Toll Free Fax (888) 797-2288

Phone (201) 797-2718

Toll Free Phone (800) 631-0347

Email sales@totalcomp.com

Website www.totalcomp.com